

IT-36CIID



## FEATURES

- Rigorously tested to ensure decades of use
- Exceptional support from Madison, WI-based Customer Care team
- Ready to be fitted with custom panels and handles to blend with cabinetry
- Over-and-under refrigerator/freezer storage
- Dual refrigeration keeps food fresher longer
- Automatic ice maker with "max ice" feature
- Air purification system fights spoilage, odors
- Internal water dispenser works with seamless design
- Water-filtration system reduces contaminants, chlorine taste and odor

## ACCESSORIES

- 36" Drawer Panels with Pro Handles
- 36" Drawer Panels with Tubular Handles
- 54" Stainless Steel Kickplate
- 60" Stainless Steel Kickplate
- 66" Stainless Steel Kickplate
- 72" Stainless Steel Kickplate
- Air Purification Cartridge
- Dual Installation Kit Handle to Handle
- Dual Installation Kit Hinge to Handle
- Dual Installation Kit Hinge to Hinge
- Egg Container
- Reduced Toekick Divider
- Stainless Steel 36" Drawer Panels with Pro Handles
- Stainless Steel 36" Drawer Panels with Tubular Handles
- Stainless Steel Door Panel with Pro Handle - LH
- Stainless Steel Door Panel with Pro Handle - RH
- Stainless Steel Side Panel
- Stainless Steel Top Panel
- Water Filter 4204490
- Stainless Steel Tubular Handles
- Stainless Steel Pro Handles

Accessories are available through an authorized dealer.  
For local dealer information, visit [subzero-wolf.com/locator](http://subzero-wolf.com/locator).



## HANDLE ACCESSORIES

PRO



TUBULAR



## PRODUCT DETAILS

### REFRIGERATOR

- Three adjustable glass shelves
- One stationary shelf
- Crisper drawer with two adjustable dividers
- Adjustable dairy compartment
- Two adjustable door shelves
- One stationary door shelf

### FREEZER

- Three adjustable drawer dividers
- Removable ice container
- Automatic ice maker

**PRODUCT SPECIFICATIONS**

Model	IT-36CIID
Dimensions	36"W x 84"H x 24"D
Door Clearance	34 1/2"
Drawer Clearance	18 3/8"
Weight	460 lbs
Refrigerator Capacity	13.3 cu. ft.
Freezer Capacity	6.4 cu. ft.
Electrical Supply	115 VAC, 60 Hz
Electrical Service	15 amp dedicated circuit
Receptacle	3-prong grounding-type

**DIMENSIONS**

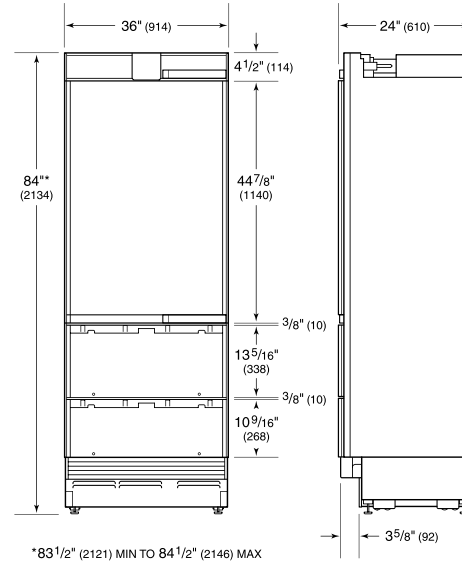

**ELECTRICAL**

**PLUMBING**

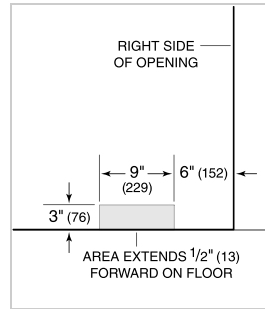
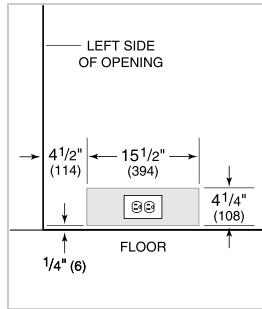

**PANEL SPECIFICATIONS** For complete panels specifications including width/height, weight requirements and thickness requirements visit [subzero-wolf.com/reveal](http://subzero-wolf.com/reveal).

**NOTE:** Dimensions in parenthesis are in millimeters unless otherwise specified

**INTERIOR VIEW**

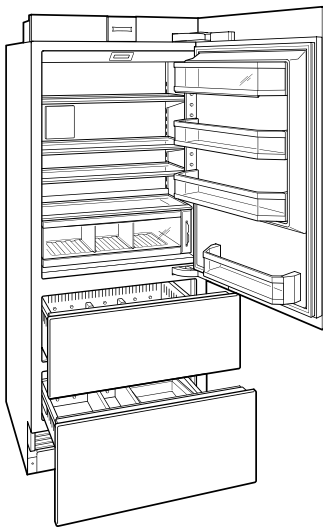

This illustration is intended for interior reference only and may not represent the exterior of the model being specified.

**STANDARD INSTALLATION**

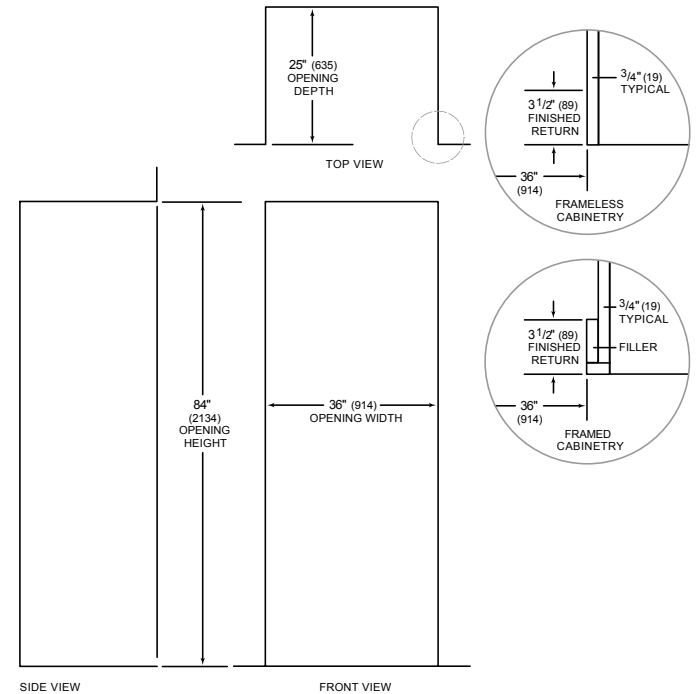

**NOTE:** 3 1/2" (89) finished returns will be visible and should be finished to match cabinetry