

1335 HOWE STREET
VANCOUVER | BRITISH COLUMBIA

1335 HOWE

AVAILABLE
FALL 2021



PRIME BEACH DISTRICT RETAIL LOCATION

ONNI.COM

Hilary Turnbull
604.488.8988 | hturnbull@onni.com

onni[®]
group

1335 HOWE STREET
VANCOUVER | BRITISH COLUMBIA

1335 HOWE

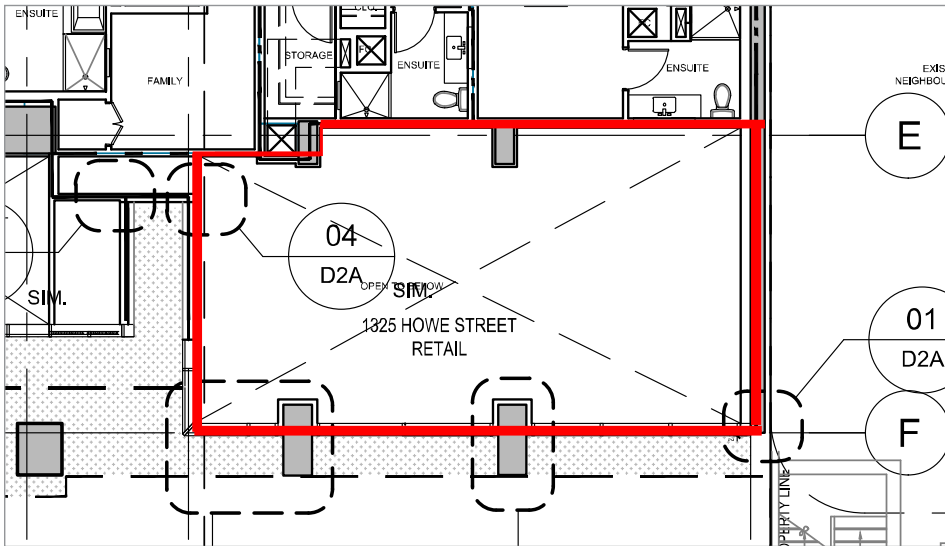

THE DEVELOPMENT

This iconic, 40-storey tower is located in the Beach District appeals to local and global audiences. 1335 Howe is a modern designed mixed-used development featuring ground floor retail with residential units above.

THE OPPORTUNITY

Available Retail Area: 825 sq.ft.

Lease Rate: Inquire for Details



LOCATION

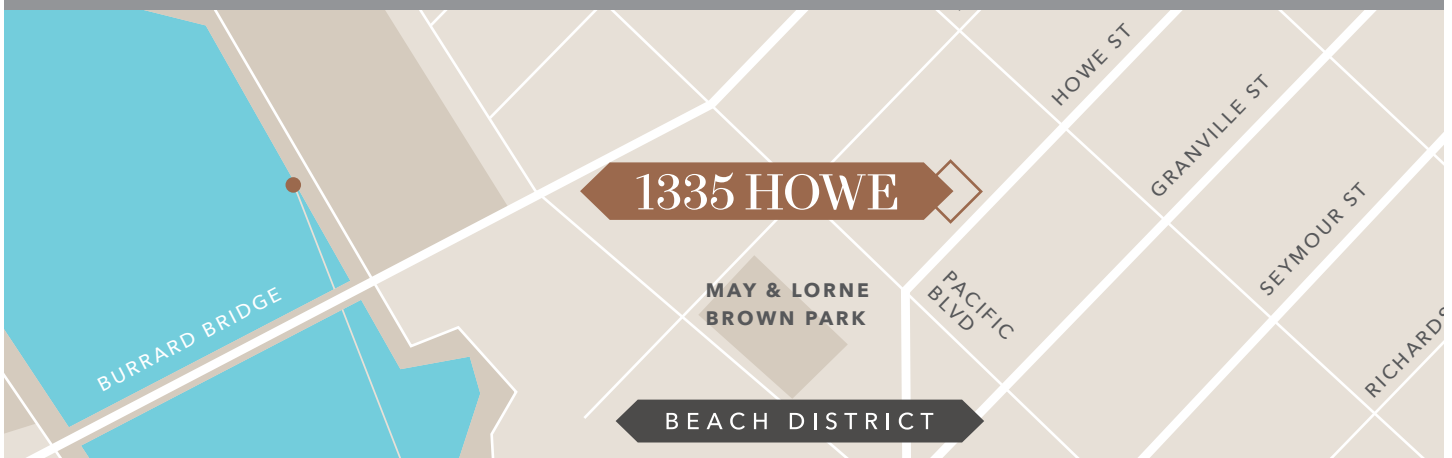

ONNI.COM

Hilary Turnbull
604.488.8988 | hturnbull@onni.com

onni[®]
group