



550 ROBSON ST.

OFFICE SPACE FOR LEASE
550 ROBSON STREET, VANCOUVER, B.C.

onni[®]
group

SEYMOUR STREET

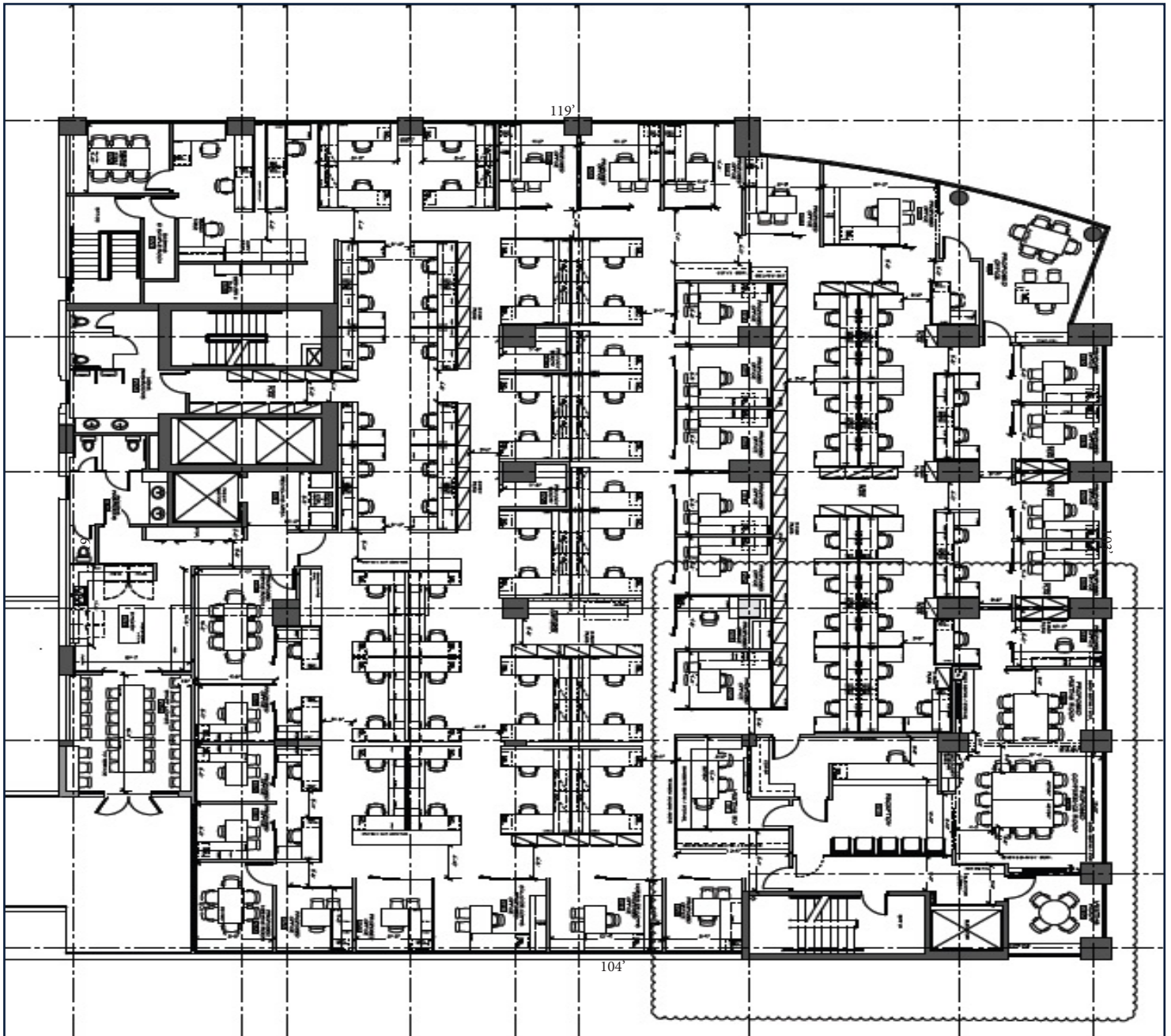

ROBSON STREET

FEATURES

- Recently renovated office space
- Includes 5 boardrooms and outdoor terrace
- Underground parking in the building
- Approximately 13,000 SF of office space

AVAILABILITY

- Unit 300 - 550 Robson Street, Vancouver
- 13,000 SF office space - Available January 2019

PRIME LOCATION IN THE HEART OF DOWNTOWN VANCOUVER

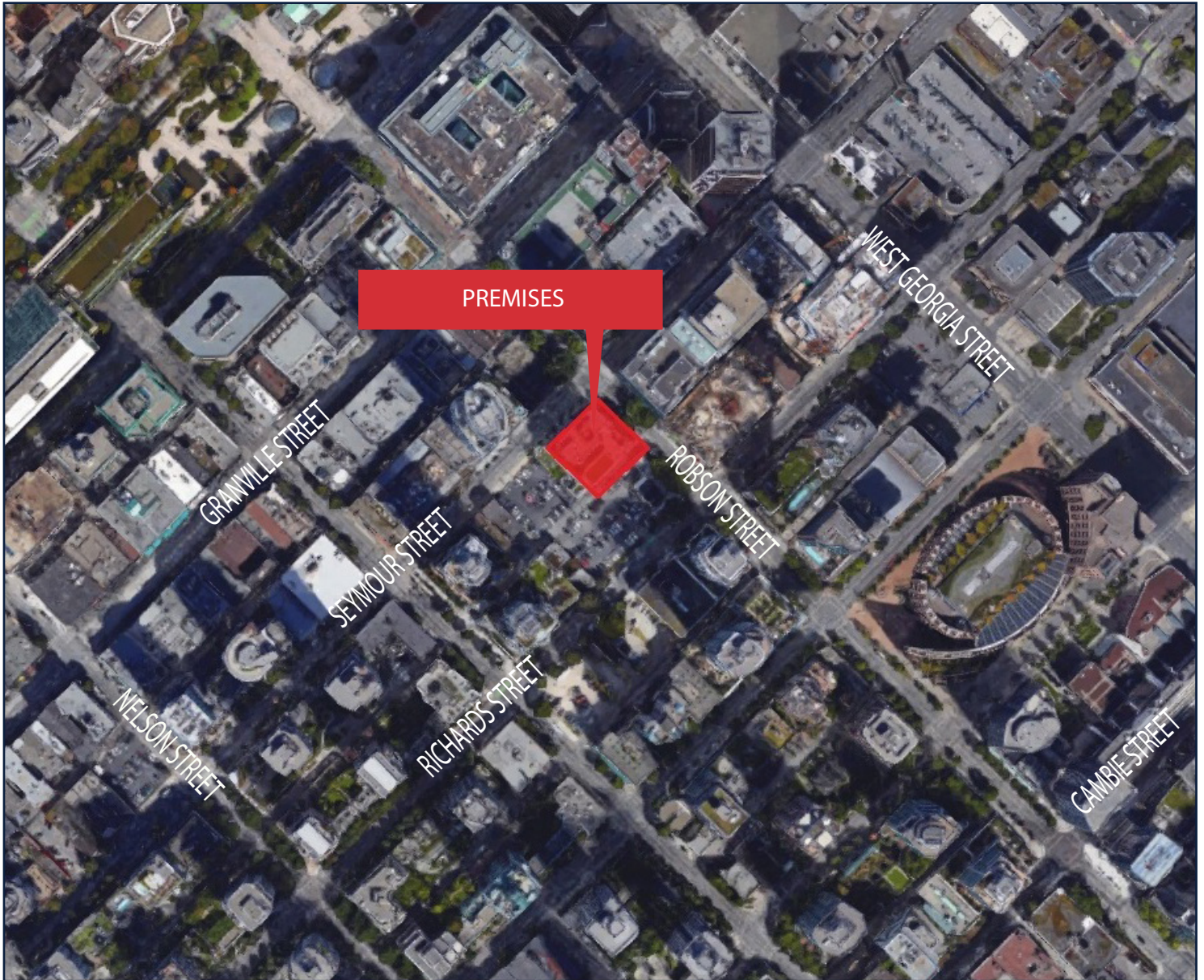

LOCATION

- Optimal location on the corner of Robson Street and Seymour Street
- Walking distance to Pacific Centre, Robson Street Shopping District, Rogers Arena, BC Place, and many more Vancouver attractions.

TRANSIT

- Convenient and easy access to the Millennium Line, Expo Line and Canada Line
- Walking distance to major bus routes and the Seabus



JOHN MIDDLETON, VICE PRESIDENT, LEASING | 604.602.7711 | JMIDDLETON@ONNI.COM
ONNI GROUP | #300 - 550 ROBSON STREET, VANCOUVER, BC V6B 2B7

ONNI.COM